

**APPROVED JURISDICTIONAL DETERMINATION FORM**  
**U.S. Army Corps of Engineers**

This form should be completed by following the instructions provided in Section IV of the JD Form Instructional Guidebook.

**SECTION I: BACKGROUND INFORMATION**

**A. REPORT COMPLETION DATE FOR APPROVED JURISDICTIONAL DETERMINATION (JD):** **AUG 07 2018**

**B. ST PAUL, MN DISTRICT OFFICE, FILE NAME, AND NUMBER:** MVP-2018-00140-JLK

**C. PROJECT LOCATION AND BACKGROUND INFORMATION:**

State: Wisconsin

County/parish/borough: Brown

City: City of Pulaski

Center coordinates of site (lat/long in degree decimal format): Lat. 44.66548° N Long. -88.21264° W.

Universal Transverse Mercator: Zone 16

Name of nearest waterbody: Unnamed tributary of the Little Suamico River

Name of watershed or Hydrologic Unit Code (HUC): Lower Fox River

☒ Check if map/diagram of review area and/or potential jurisdictional areas is/are available upon request.

☐ Check if other sites (e.g., offsite mitigation sites, disposal sites, etc...) are associated with this action and are recorded on a different JD form.

**D. REVIEW PERFORMED FOR SITE EVALUATION (CHECK ALL THAT APPLY):**

☒ Office (Desk) Determination. Date: 27-July-2018

☐ Field Determination. Date(s):

**SECTION II: SUMMARY OF FINDINGS**

**A. RHA SECTION 10 DETERMINATION OF JURISDICTION.**

There are no "navigable waters of the U.S." within Rivers and Harbors Act (RHA) jurisdiction (as defined by 33 CFR part 329) in the review area.

**B. CWA SECTION 404 DETERMINATION OF JURISDICTION.**

There are no "waters of the U.S." within Clean Water Act (CWA) jurisdiction (as defined by 33 CFR part 328) in the review area.

**SECTION III: CWA ANALYSIS**

**A. TNWs AND WETLANDS ADJACENT TO TNWs:** N/A

**B. CHARACTERISTICS OF TRIBUTARY (THAT IS NOT A TNW) AND ITS ADJACENT WETLANDS (IF ANY):** N/A

**C. SIGNIFICANT NEXUS DETERMINATION:** N/A

**D. DETERMINATIONS OF JURISDICTIONAL FINDINGS. THE SUBJECT WATERS/WETLANDS ARE (CHECK ALL THAT APPLY):** N/A

**E. ISOLATED [INTERSTATE OR INTRA-STATE] WATERS, INCLUDING ISOLATED WETLANDS, THE USE, DEGRADATION OR DESTRUCTION OF WHICH COULD AFFECT INTERSTATE COMMERCE, INCLUDING ANY SUCH WATERS (CHECK ALL THAT APPLY):** N/A

**F. NON-JURISDICTIONAL WATERS, INCLUDING WETLANDS (CHECK ALL THAT APPLY):**

☐ If potential wetlands were assessed within the review area, these areas did not meet the criteria in the 1987 Corps of Engineers

☒ Other: (explain, if not covered above): **After reviewing information submitted by the applicant, it was determined this area contained only uplands and no aquatic resources.**

**SECTION IV: DATA SOURCES.**

**A. SUPPORTING DATA. Data reviewed for JD (check all that apply - checked items shall be included in case file and, where checked and requested, appropriately reference sources below):**

☒ Maps, plans, plots or plat submitted by or on behalf of the applicant/consultant: Pulaski Industrial Park Project Wetland Delineation Report 8/2017

☒ Data sheets prepared/submitted by or on behalf of the applicant/consultant.

☐ Office concurs with data sheets/delineation report.

☐ Office does not concur with data sheets/delineation report.

☐ Data sheets prepared by the Corps:

☐ Corps navigable waters' study:

☐ U.S. Geological Survey Hydrologic Atlas:

☐ USGS NHD data.

- ☐ USGS 8 and 12 digit HUC maps.
- ☐ U.S. Geological Survey map(s). Cite scale & quad name:
- ☐ USDA Natural Resources Conservation Service Soil Survey. Citation:
- ☐ National wetlands inventory map(s). Cite name:
- ☒ State/Local wetland inventory map(s): **Surface Water Data Viewer Map**
- ☐ FEMA/FIRM maps:
- ☐ 100-year Floodplain Elevation is: (National Geodetic Vertical Datum of 1929)
- ☒ Photographs: ☒ Aerial (Name & Date): **Pulaski Industrial Park Project Wetland Delineation Report 8/2017**  
or ☒ Other (Name & Date): **Pulaski Industrial Park Project Wetland Delineation Report 8/2017**
- ☐ Previous determination(s). File no. and date of response letter:
- ☐ Applicable/supporting case law:
- ☐ Applicable/supporting scientific literature:
- ☐ Other information (please specify):

**B. ADDITIONAL COMMENTS TO SUPPORT JD:**

# BAY TEK GAMES INC. SITE MODIFICATIONS FOR BAYLAND BUILDINGS, INC. VILLAGE OF PULASKI, BROWN COUNTY, WISCONSIN

ATTENTION!  
DOWNLOADED PLANS ARE NOT SCALEABLE, NEITHER THE OWNER OR THE ENGINEER SHALL BE HELD RESPONSIBLE FOR THE SCALE OR PRINT QUALITY OF DOWNLOADED PLANS. ONLY PRINTED PLANS FROM BLUE PRINT SERVICE CO., INC. SHALL BE CONSIDERED TO BE SCALEABLE PLANS.

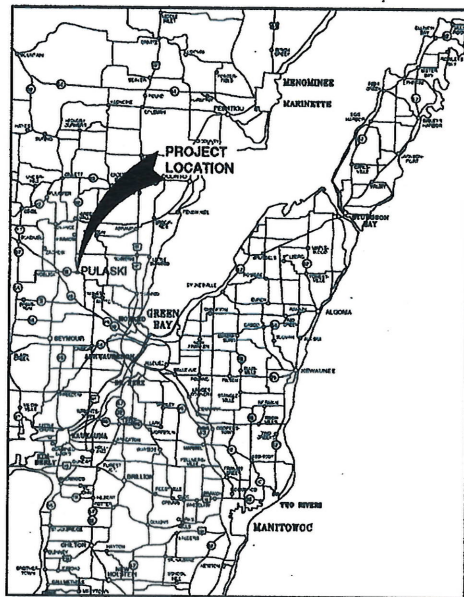

VICINITY MAP

NOTE:  
EXISTING UTILITIES SHOWN ON PLANS ARE APPROXIMATE. THE CONTRACTOR SHALL BE RESPONSIBLE FOR OBTAINING EXACT LOCATIONS AND ELEVATIONS OF ALL UTILITIES, WHETHER SHOWN OR NOT, FROM THE OWNERS OF THE RESPECTIVE UTILITIES. ALL UTILITY OWNERS SHALL BE NOTIFIED FOR LOCATES BY THE CONTRACTOR 72 HOURS PRIOR TO EXCAVATION.

NOTE:  
ALL EROSION CONTROL MEASURES SHALL BE IN PLACE PRIOR TO CONSTRUCTION AND SHALL CONFORM TO THE WISCONSIN DEPARTMENT OF NATURAL RESOURCES' CONSTRUCTION SITE EROSION CONTROL AND TECHNICAL STANDARDS.

## INDEX TO DRAWINGS

SHT. NO.	DESCRIPTION
1	LOCATION MAPS AND INDEX TO DRAWINGS
2	EXISTING SITE CONDITIONS
3	SITE PLAN
4	UTILITY PLAN
5	GRADING PLAN
6	CONTOUR AND EROSION CONTROL PLAN
7	MISCELLANEOUS DETAILS
8	MISCELLANEOUS DETAILS
9	EROSION CONTROL - INLET PROTECTION AND MISCELLANEOUS DETAILS
10	EROSION CONTROL - DITCH CHECK DETAILS
11	EROSION CONTROL - SHEET FLOW DETAILS
P1	EXISTING REGIONAL POND CONDITIONS
P2	OVERALL POND
P3	POND DETAILS

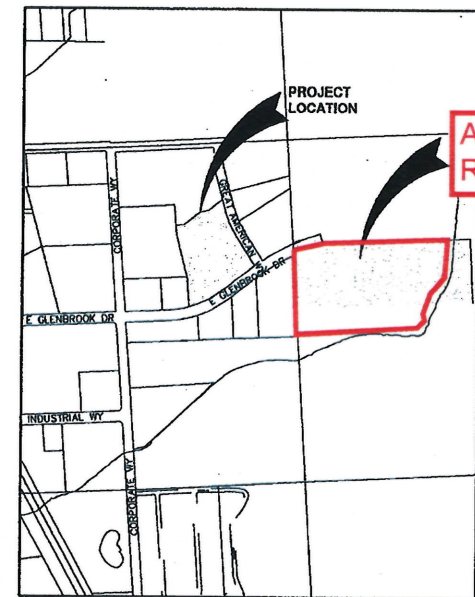

LOCATION MAP

NO.	DATE	APPROV.	REVISION	NO.	DATE	APPROV.	REVISION	DRAWN	BAY TEK GAMES INC. SITE MODIFICATIONS FOR BAYLAND BUILDINGS, INC. VILLAGE OF PULASKI BROWN COUNTY, WISCONSIN	DATE 2018-01-10 FILE COVER JOB NO. 2018-01	Robert E. Lee & Associates, Inc. ENGINEERING, SURVEYING, ENVIRONMENTAL SERVICES 1200 CORTLAND CENTER BOULEVARD ROSA, WI 54155 920-562-6641 www.releeinc.com	SHEET NO. 1
1	2-2-18	JOS	SD RT					CHECKED JOS				
								DESIGNED JOS				
								BY				





Land Information:  
 Project Area = 16.19 acres (705,086 Sq. Ft)  
 Wetland 1 = 0.19 acres (8,378 Sq. Ft)  
 Upland = 16.00 acres (696,708 Sq. Ft)  
 \* All measurements are estimates only

Legend:  
 — Project Area  
 — Wetland Boundary  
 ● Soil/Vegetation Sample Plot

Figure 5 Wetland Delineation Map Robert E. Lee & Associates Bema Property (Parcel - P178) Pittsfield, Wisconsin Brown County GIS 2017 Aerial Photo <b>BAY</b> Environmental SOLUTIONS, INC.	Figure 5 Wetland Delineation Map	
	Client:	REL
	Date:	Oct 2017
	Scale:	1" = 170'
		Drawn By: TLB