

**APPROVED JURISDICTIONAL DETERMINATION FORM**  
**U.S. Army Corps of Engineers**

This form should be completed by following the instructions provided in Section IV of the JD Form Instructional Guidebook.

**SECTION I: BACKGROUND INFORMATION**

- A. REPORT COMPLETION DATE FOR APPROVED JURISDICTIONAL DETERMINATION (JD):** **MAR 08 2019**
- B. ST PAUL, MN DISTRICT OFFICE, FILE NAME, AND NUMBER:** River Valley Industries Site, Village of Hobart (Wetlands 1-E(D) and 3-E(D)/ 2019-00156-JLK
- C. PROJECT LOCATION AND BACKGROUND INFORMATION:**  
State: Wisconsin County/parish/borough: Brown City: Hobart  
Center coordinates of site (lat/long in degree decimal format): Lat. 44.45544° N, Long. -88.12803° E  
Universal Transverse Mercator: Zone 16  
Name of nearest waterbody: Dutchman Creek  
Name of watershed or Hydrologic Unit Code (HUC): Lower Fox (04030204)  
☒ Check if map/diagram of review area and/or potential jurisdictional areas is/are available upon request.  
☐ Check if other sites (e.g., offsite mitigation sites, disposal sites, etc...) are associated with this action and are recorded on a different JD form.
- D. REVIEW PERFORMED FOR SITE EVALUATION (CHECK ALL THAT APPLY):**  
☒ Office (Desk) Determination. Date: January 23, 2019  
☐ Field Determination. Date(s):

**SECTION II: SUMMARY OF FINDINGS**

**A. RHA SECTION 10 DETERMINATION OF JURISDICTION.**

There are no "navigable waters of the U.S." within Rivers and Harbors Act (RHA) jurisdiction (as defined by 33 CFR part 329) in the review area.

**B. CWA SECTION 404 DETERMINATION OF JURISDICTION.**

There are no "waters of the U.S." within Clean Water Act (CWA) jurisdiction (as defined by 33 CFR part 328) in the review area.

**1. Waters of the U.S.: N/A**

**2. Non-regulated waters/wetlands (check if applicable):<sup>1</sup>**

- ☒ Potentially jurisdictional waters and/or wetlands were assessed within the review area and determined to be not jurisdictional.  
Explain: **The review area contains two aquatic resources (labeled as Wetland 1-E(D) and Wetland 3-E(D) on Figures) that are isolated depressions with no surface or shallow subsurface connection to any waters of the U.S. including the nearest tributary which is Dutchman Creek located approximately 5,000 feet to the northwest. These wetlands do not border, neighbor, nor are contiguous with another water of the U.S. They are not separated from other waters of the United States (WOUS) by man-made dikes, barriers, or berms. The surrounding land use consists mostly of agricultural fields and commercial development, precluding an ecological connection to a WOUS.**

**These aquatic resources do not support a link to interstate foreign or commerce; are not known to be used by interstate or foreign travelers for recreation or other purposes; do not produce fish or shellfish that could be taken and sold in interstate or foreign commerce; and are not known to be used for industrial purposes by industries in interstate commerce. Therefore, the Corps has determined these aquatic features are not regulated by the Corps under Section 404 of the Clean Water Act.**

**SECTION III: CWA ANALYSIS**

- A. TNWs AND WETLANDS ADJACENT TO TNWs: N/A**
- B. CHARACTERISTICS OF TRIBUTARY (THAT IS NOT A TNW) AND ITS ADJACENT WETLANDS (IF ANY): N/A**
- C. SIGNIFICANT NEXUS DETERMINATION: N/A**
- D. DETERMINATIONS OF JURISDICTIONAL FINDINGS. THE SUBJECT WATERS/WETLANDS ARE (CHECK ALL THAT APPLY): N/A**

<sup>1</sup> Supporting documentation is presented in Section III.F.

E. ISOLATED [INTERSTATE OR INTRA-STATE] WATERS, INCLUDING ISOLATED WETLANDS, THE USE, DEGRADATION OR DESTRUCTION OF WHICH COULD AFFECT INTERSTATE COMMERCE, INCLUDING ANY SUCH WATERS (CHECK ALL THAT APPLY): N/A

F. NON-JURISDICTIONAL WATERS, INCLUDING WETLANDS (CHECK ALL THAT APPLY):

- ☐ If potential wetlands were assessed within the review area, these areas did not meet the criteria in the 1987 Corps of Engineers Wetland Delineation Manual and/or appropriate Regional Supplements.
- ☒ Review area included isolated waters with no substantial nexus to interstate (or foreign) commerce.
  - ☒ Prior to the Jan 2001 Supreme Court decision in "SWANCC," the review area would have been regulated based solely on the "Migratory Bird Rule" (MBR).
- ☐ Waters do not meet the "Significant Nexus" standard, where such a finding is required for jurisdiction. Explain:
- ☐ Other (explain, if not covered above):

Provide acreage estimates for non-jurisdictional waters in the review area, where the sole potential basis of jurisdiction is the MBR factors (i.e., presence of migratory birds, presence of endangered species, use of water for irrigated agriculture), using best professional judgment (check all that apply):

- ☐ Non-wetland waters (i.e., rivers, streams): linear feet width (ft).
- ☐ Lakes/ponds: acres.
- ☐ Other non-wetland waters: acres. List type of aquatic resource:
- ☒ Wetlands: Wetlands 1-E(D) and 3-E(D): Totaling 0.16 acres.

Provide acreage estimates for non-jurisdictional waters in the review area that do not meet the "Significant Nexus" standard, where such a finding is required for jurisdiction (check all that apply):

- ☐ Non-wetland waters (i.e., rivers, streams): linear feet, width (ft).
- ☐ Lakes/ponds: acres.
- ☐ Other non-wetland waters: acres. List type of aquatic resource:
- ☐ Wetlands: acres.

**SECTION IV: DATA SOURCES.**

A. SUPPORTING DATA. Data reviewed for JD (check all that apply - checked items shall be included in case file and, where checked and requested, appropriately reference sources below):

- ☒ Maps, plans, plots or plat submitted by or on behalf of the applicant/consultant: NES Ecological Services Wetland Delineation 2016
- ☒ Data sheets prepared/submitted by or on behalf of the applicant/consultant.
  - ☐ Office concurs with data sheets/delineation report.
  - ☐ Office does not concur with data sheets/delineation report.
- ☐ Data sheets prepared by the Corps:
- ☐ Corps navigable waters' study:
- ☒ U.S. Geological Survey Hydrologic Atlas:
  - ☒ USGS NHD data.
  - ☐ USGS 8 and 12 digit HUC maps.
- ☐ U.S. Geological Survey map(s). Cite scale & quad name:
- ☒ USDA Natural Resources Conservation Service Soil Survey. Citation: Brown County
- ☐ National wetlands inventory map(s). Cite name:
- ☒ State/Local wetland inventory map(s): Wisconsin Wetland Inventory
- ☐ FEMA/FIRM maps:
- ☐ 100-year Floodplain Elevation is: (National Geodetic Vertical Datum of 1929)
- ☒ Photographs: ☒ Aerial (Name & Date): 2016 Wetland Delineation Report
  - or ☒ Other (Name & Date): Ground level photos
- ☐ Previous determination(s). File no. and date of response letter:
- ☐ Applicable/supporting case law:
- ☐ Applicable/supporting scientific literature:
- ☐ Other information (please specify):

B. ADDITIONAL COMMENTS TO SUPPORT JD:

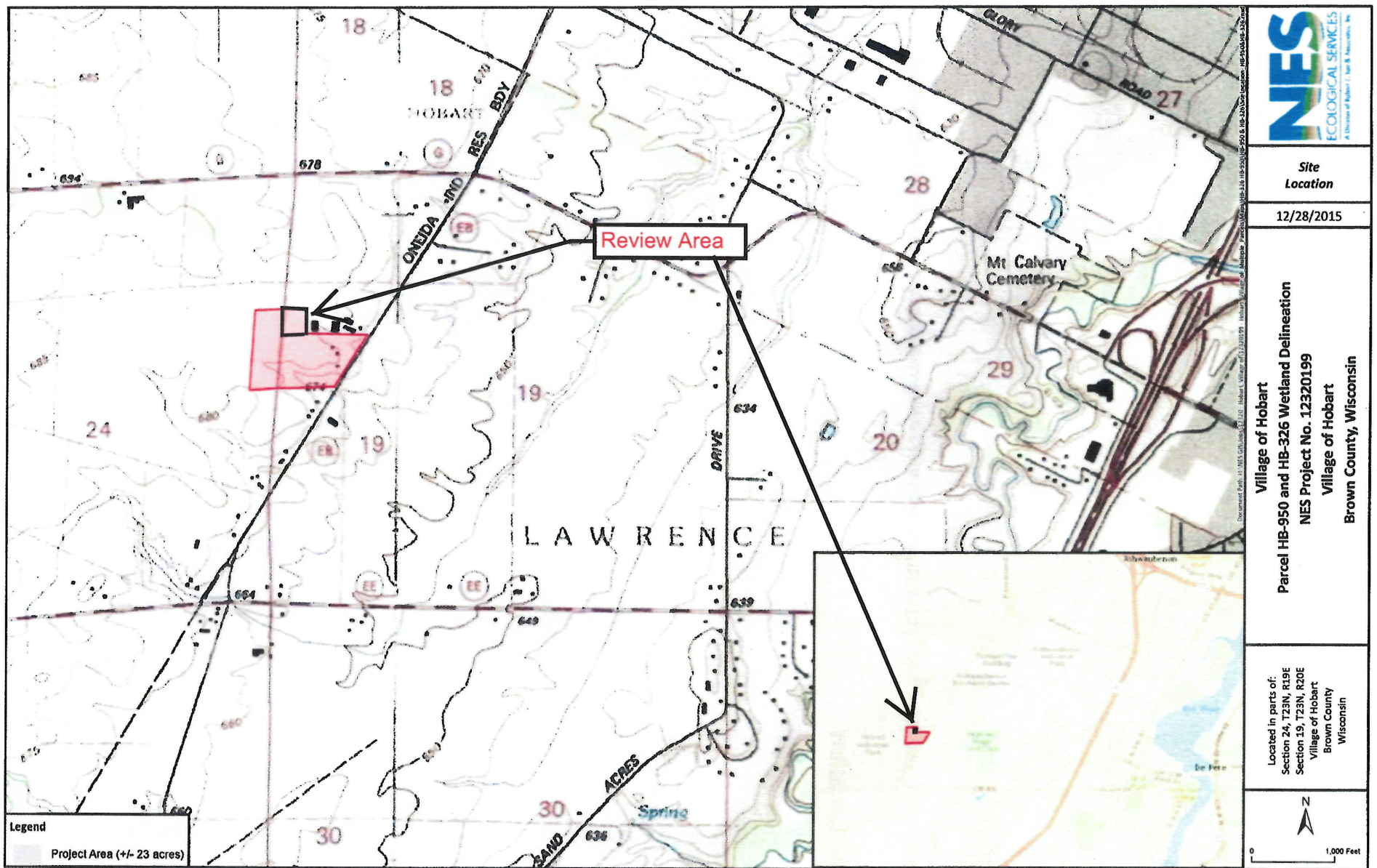

Site  
Location

12/28/2015

Village of Hobart  
Parcel HB-950 and HB-326 Wetland Delineation  
NES Project No. 12320199  
Village of Hobart  
Brown County, Wisconsin

Located in parts of:  
Section 24, T23N, R19E  
Section 19, T23N, R20E  
Village of Hobart  
Brown County  
Wisconsin

2019-00156-JLK (Figure 1 of 2)



